

# UCFC 200 (normal-duty)

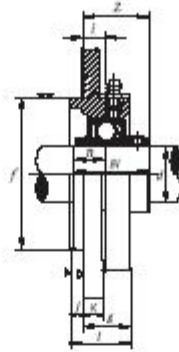

SR type seal

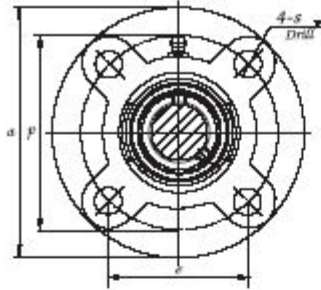

TRL type seal

Bearing unit No.	Shaft Dia.		Dimensions (in.) or (mm)													Bolt used		Bearing No.	Housing No.	Weight (kg)	
	d		a	p	e	l	l	s	j	k	g	f	z	Bl	n	(mm)	(in.)				
	(in.)	(mm)																			
UCFC 201 201-8	1 1/2	12	3 15/16 100	3 3/64 78	2 11/64 55.1	10 10	1	25.5	12	5	7	20.5	2.4409 62	1 1/8 28.3	1.2205 31.0	0.5000 12.7	M10	3/8	UC 201 201-8	FC 201	0.78
UCFC 202 202-10	5/8	15	3 15/16 100	3 3/64 78	2 11/64 55.1	10 10	1	25.5	12	5	7	20.5	2.4409 62	1 1/8 28.3	1.2205 31.0	0.5000 12.7	M10	3/8	UC 202 202-10	FC 202	0.78
UCFC 203 203-11	11/16	17	3 5/16 100	3 3/64 78	2 11/64 55.1	10 10	1	25.5	12	5	7	20.5	2.4409 62	1 1/8 28.3	1.2205 31.0	0.5000 12.7	M10	3/8	UC 203 203-11	FC 203	0.78
UCFC 204-12 204	3/4	20	3 7/16 100	3 3/64 78	2 11/64 55.1	10 10	1	25.5	12	5	7	20.5	2.4409 62	1 1/8 28.3	1.2205 31.0	0.5000 12.7	M10	3/8	UC 204-12 204	FC 204	0.78
UCFC 205-14 205-15 205 205-16	1 1/8 1 1/16 1	25	4 1/2 115	3 3/64 90	2 1/8 63.6	10 10	1	27	12	6	7	21	2.7559 70	1 5/16 29.7	1.3386 34	0.5630 14.3	M10	3/8	UC 205-14 205-15 205 205-16	FC 205	0.95
UCFC 206-18 206 206-19 206-20	1 1/8 1 1/16 1 1/8	30	4 29/32 125	3 15/64 100	2 35/64 70.7	10 10	1	31	12	8	8	23	3.1496 80	1 9/32 32.2	1.5000 38.1	0.6260 15.9	M10	3/8	UC 206-18 206 206-19 206-20	FC 206	1.4
UCFC 207-20 207-21 207-22 207 207-23	1 1/8 1 1/16 1 1/8 1 1/8	35	5 1/4 135	4 1/16 110	3 1/16 77.8	11 11	1	34	14	8	9	26	3.5433 90	1 1/2 36.4	1.6890 42.9	0.6890 17.5	M12	7/16	UC 207-20 207-21 207-22 207 207-23	FC 207	1.7
UCFC 208-24 208-25 208	1 1/2 1 1/16	40	5 23/32 145	4 21/32 120	3 11/32 84.8	11 11	1	36	14	10	9	26	3.9370 100	1 5/8 41.2	1.9370 49.2	0.7480 19.0	M12	7/16	UC 208-24 208-25 208	FC 208	2.0
UCFC 209-26 209-27 209-28 209	1 1/8 1 1/4 1 3/4	45	6 1/4 160	5 11/16 132	4 31/64 93.3	10 10	1	38	16	12	10	26	4.1339 105	1 31/32 40.2	1.9370 49.2	0.7480 19.0	M14	1/2	UC 209-26 209-27 209-28 209	FC 209	2.8
UCFC 210-30 210-31 210	1 1/8 1 1/16	50	6 1/2 165	5 7/16 138	4 27/32 97.6	10 10	1	40	16	12	14	28	4.3307 110	1 11/16 42.6	2.0315 51.6	0.7480 19.0	M14	1/2	UC 210-30 210-31 210	FC 210	3.0
UCFC 211-32 211-34 211 211-35	3/4 2 1/4 2 3/16	55	7 1/2 185	6 29/32 150	4 11/64 106.1	13 13	1	42	19	12	15	31	4.9213 125	1 11/16 46.4	2.1890 55.6	0.8740 22.2	M16	5/8	UC 211-32 211-34 211 211-35	FC 211	4.0
UCFC 212-36 212 212-38 212-39	2 1/4 2 3/4 2 3/4	60	7 11/16 195	6 19/64 160	4 29/64 113.1	17 17	1	48	19	12	15	36	5.3150 135	2 1/2 56.7	2.5630 65.1	1.0000 25.4	M16	5/8	UC 212-36 212 212-38 212-39	FC 212	4.7
UCFC 213-40 213	2 1/2	65	8 1/16 205	6 1/16 170	4 47/64 120.2	16 16	1	50	19	14	16	36	5.7087 145	2 11/16 55.7	2.5630 65.1	1.0000 25.4	M16	5/8	UC 213-40 213	FC 213	5.4
UCFC 214-44 214	2 3/4	70	8 3/8 215	6 3/8 177	4 39/64 125.1	17 17	1	54	19	14	16	40	5.9055 150	2 31/32 61.4	2.9370 74.6	1.1890 30.2	M16	5/8	UC 214-44 214	FC 214	6.8
UCFC 215 215-48	3	75	8 3/4 220	6 3/4 184	4 5/8 130.1	18 18	1	56	19	16	18	40	6.2992 160	2 31/32 62.5	3.0630 77.8	1.3110 33.3	M16	5/8	UC 215 215-48	FC 215	7.3
UCFC 216		80	9 1/16 240	7 1/4 200	4 59/64 141.4	18 18	1	58	23	16	18	42	6.6929 170	2 29/32 67.3	3.2520 82.6	1.3110 33.3	M20	3/4	UC 216	FC 216	8.9
UCFC 217-52 217	3 1/4	85	9 29/32 250	8 3/8 208	5 39/64 147.1	18 18	1	63	23	18	20	45	7.0866 180	2 3/4 69.6	3.3740 85.7	1.3425 34.1	M20	3/4	UC 217-52 217	FC 217	10.4
UCFC 218-56 218	3 1/2	90	10 1/4 265	8 3/4 220	5 3/4 155.5	22 22	1	68	23	18	20	50	7.4803 190	3 1/8 78.3	3.7795 96.0	1.5630 39.7	M20	3/4	UC 218-56 218	FC 218	13.0